



DZ47-63 1P



DZ47-63 2P



DZ47-63 3P



DZ47-63 4P

1. Application

DZ47-63 is applicable to a line of AC 50/60Hz, 230V in single pole, 400V in double, three, four poles for protecting overload and short circuit, and rated current up to 63A. It can also be used for infrequent line conversion under the normal condition. The breaker is applicable to lighting distribution system in industrial enterprise, commercial district, high-rise building and dwelling house. It conforms with the standards of IEC60898.

2. Main Technical Parameter

Type	DZ47-63			
Pole	1P		2P, 3P, 4P	
Rated current (A)	6, 10, 16, 20, 25, 32, 40, 50, 63			
Rated voltage(V)	230		400	
Ambient temperature	-5°C~+40°C			
Type of instantaneous release	C	D	C	D
Rated short circuit breaking capacity Icu(KA)	6	4	6	4

3. Applicable Conducting Wire

Rated current(A)	Normal cross section of wire mm ²
1-6A	1
10A	1.5
16,20A	2.5
25A	4
32A	6
40,50A	10
63A	16

4. The Over-current Protection Property

Ambient temperature	Initial status	Test current	Test time	Expected result	Note
30±2°C	Cold position	1.13In	t ≥ 1h	Non-release	-
	Carried out immediately after previous test	1.45In	t < 1h	Release	-
	Cold position	2.55In	1s < t < 60s (In ≤ 32A)	Release	Current smoothly rises to specified value within 5s
	Cold position	2.55In	1s < t < 120s (In ≤ 32A)	Release	
-5~+40°C	Cold position	3In	t ≥ 0.1s	Non-release	Type B
	Cold position	5In	t < 0.1s	Release	Type B
	Cold position	5In	t ≥ 0.1s	Non-release	Type C
	Cold position	10In	t < 0.1s	Release	Type C
	Cold position	10In	t ≥ 0.1s	Non-release	Type D
	Cold position	20In	t < 0.1s	Release	Type D

5. Dimension

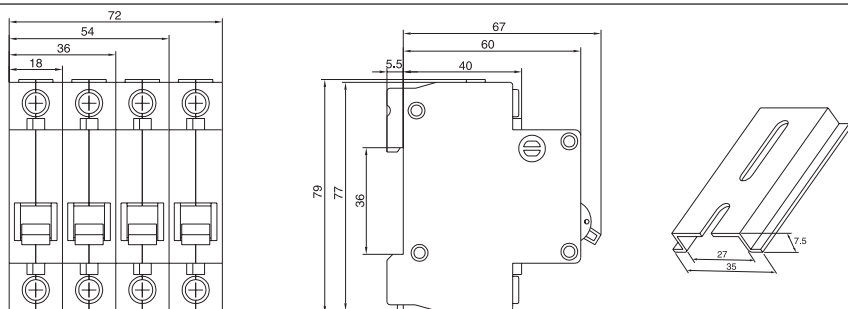



DZ47LE-63 1P+N



DZ47LE-63 2P



DZ47LE-63 3P



DZ47LE-63 4P

1. Application

DZ47LE-63 is applicable to a line of AC 50/60Hz, rated voltage 230V for single pole two-wire, 2-pole or 400V for 3-pole, 3-pole 4-wire, 4-pole and rated current up to 40A. It can protect the line and motor from overload and short circuit. It can also be used for infrequent line conversion and infrequent motor start. It conforms with the standards of IEC61009.

2. Main Technical Parameter

Type	DZ47LE-63	
Pole	1P+N, 2P	3P, 3P+N, 4P
Rated current (A)	6, 10, 16, 20, 25, 32, 40, 50, 63	
Rated voltage (V)	230	400
Rated short circuit breaking capacity I _{cu} (KA)	6	
Rated residual making/breaking capacity I _{Δm} (A)	2000	
Rated residual action current I _{Δn} (A)	0.03, 0.05, 0.1, 0.3	
Rated residual non-action current I _{Δno} (A)	0.5I _{Δn}	

3. Applicable Conducting Wire

Rated current(A)	1-6A	10A	16,20A	25A	32A	40,50A	63A
Norminal cross section of wire mm ²	1	1.5	2.5	4	6	10	16

4. Residual Current Breaking Time

I _n (A)	I _{Δn} (A)	Breaking time(s) when equals to rating following				
		I _{Δn}	2I _{Δn}	5I _{Δn}	5, 10, 20, 50, 100, 200, 500 ² (A)	I _{Δt} ^b
6-63	0.03, 0.05, 0.1, 0.3	0.1	0.06	0.04	0.04	0.04

5. The Over-current Protection Property

Ambient temperature	Initial status	Test current	Test time	Expected result	Note
30±2°C	Cold position	1.13I _n	t ≥ 1h	Non-release	-
	Carried out immediately after previous test	1.45I _n	t < 1h	Release	-
	Cold position	2.55I _n	1s < t < 60s (I _n ≤ 32A)	Release	Current smoothly rises to specified value within 5s
	Cold position	2.55I _n	1s < t < 120s (I _n [32A)	Release	
-5~+40°C	Cold position	3I _n	t ≥ 0.1s	Non-release	Type B
	Cold position	5I _n	t < 0.1s	Release	Type B
	Cold position	5I _n	t ≥ 0.1s	Non-release	Type C
	Cold position	10I _n	t < 0.1s	Release	Type C
	Cold position	10I _n	t ≥ 0.1s	Non-release	Type D
	Cold position	20I _n	t < 0.1s	Release	Type D

6. Dimension

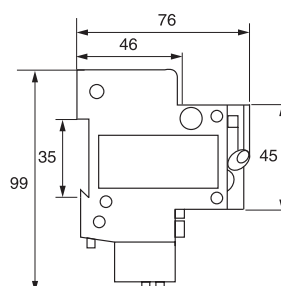
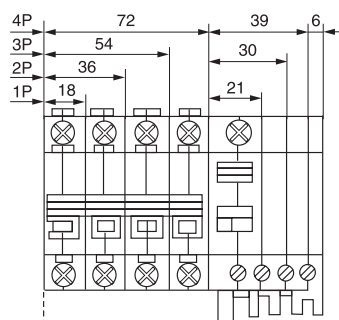

4P: 72+45
 3P+N: 54+45
 3P: 54+36
 2P: 36+27
 1P: 18
 27

1. Application

DZ47-100 is such features as delicate appearance, light weight, excellent and reliable performance, high breaking capacity, rapid tripping and mounted by rail. Its enclosure and components adopts high fire-retarding and shock-resistance plastic of long durability. It mainly serves for protecting the circuits of AC 50/60Hz, 230V of single pole, 400V of two poles or three or four poles from overload or short-circuit, and also for unfrequent making and breaking electrical apparatus and lighting circuit. It conforms with the standards of IEC60947-2.



DZ47-100 1P



DZ47-100 2P



DZ47-100 3P



DZ47-100 4P

2. Main Technical Parameter

Type	DZ47-100	
Pole	1P	2P, 3P, 4P
Rated current (A)	63, 80, 100	
Rated voltage (V)	230	400
Ambient temperature	-5°C~+40°C	
Type of instantaneous release	C, D	
Rated short circuit breaking capacity Icu(KA)	10	

3. The Over-current Protection Property

Ambient temperature	Initial status	Test current	Test time	Expected result	Note
40±2°C	Cold position	1.05In (In ≤ 63A)	t ≤ 1h	Non-release	-
	Cold position	1.05In (In > 63A)	t ≤ 2h	Non-release	-
	Carried out immediately after previous test	1.30In (In ≤ 63A) 1.30In (In > 63A)	t < 1h t < 2h	Release Release	Current smoothly rises to specified value within 5s
-5~+40°C	Cold position	8.00In	t ≤ 0.2s	Non-release	-
	Cold position	12.00In	t < 0.2s	Non-release	-

4. Applicable Conducting Wire

Rated current(A)	Nominal cross section of wire mm ²
63A	16
80A	25
100A	35

5. Dimension

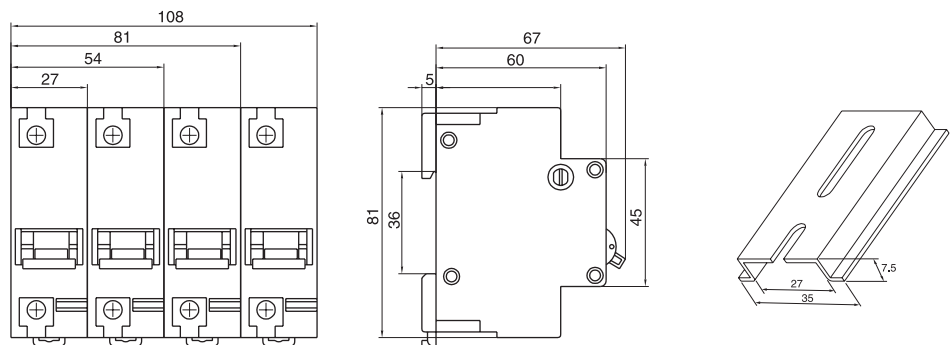

DZ47LE-100

DZ47LE-100 Residual Current Operated Circuit Breaker with Over-current Protection

KAVA®



DZ47LE-100 1P+N

1. Application

DZ47LE-100 is applicable to a line of AC 50/60Hz, rated voltage 230V for single pole two-wire, 2-pole or 400V for 3-pole, 3-pole 4-wire, 4-pole and rated current up to 40A. It can protect the line and motor from overload and short circuit. It can also be used for infrequent line conversion and infrequent motor start. It conforms with the standards of IEC60947-2.

2. Main Technical Parameter

Type	DZ47LE-100	
Pole	1P+N, 2P	3P, 3P+N, 4P
Rated current (A)	63,80,100	
Rated voltage(V)	230	400
Rated short circuit breaking capacity I _{cu} (KA)	10	
Rated residual making/breaking capacity I _{Δm} (A)	2000	
Rated residual action current I _{Δn} (A)	0.03,0.1,0.3	
Rated residual non-action current I _{Δno} (A)	0.5I _{Δn}	
Over voltage protection grade	280V±5%	



DZ47LE-100 2P

3. Applicable Conducting Wire

Rated current(A)	63	80	100
Nominal cross section of wire mm ²	16	25	35

4. Residual Current Breaking Time

I _n (A)	I _{Δn} (A)	Breaking time(s) when equals to rating following					I _{Δt^b}
		I _{Δn}	2I _{Δn}	5I _{Δn}	5,10,20,50,100,200,500 ^a (A)	I _{Δt^b}	
6-63	0.03, 0.05, 0.1, 0.3	0.1	0.06	0.04	0.04		0.04



DZ47LE-100 3P

5. The Over-current Protection Property

Ambient temperature	Initial status	Test current	Test time	Expected result	Note
40±2°C	Cold position	1.05I _n (I _n ≤ 63A)	t ≤ 1h	Non-release	—
	Cold position	1.05I _n (I _n [63A)	t ≤ 2h	Non-release	—
	Carried out immediately after previous test	1.30I _n (I _n ≤ 63A) 1.30I _n (I _n > 63A)	t < 1h t < 2h	Release Release	Current smoothly rises to specified value within 5s
-5~+40°C	Cold position	8.00I _n	t ≤ 0.2s	Non-release	—
	Cold position	12.00I _n	t < 0.2s	Non-release	—

6. Dimension



DZ47LE-100 3P+N

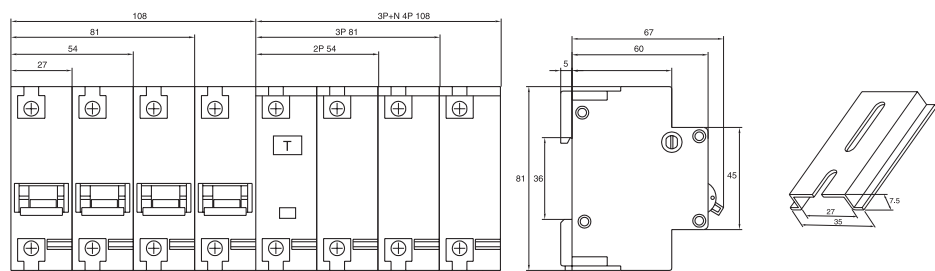



DZ30-32

1. Application

DZ30-32 is used in the single phase circuit of AC 50/60Hz, rated voltage 230V or below for protecting circuit from overload and short circuit. This product has advantages of high breaking capacity, small volume, width is only 18mm. It conforms with the standards of IEC60898.

2. Main Technical Parameter

Type	DZ30-32
Pole	1P+N
Rated current (A)	6,10,16,20,25,32
Rated voltage(V)	230
Type of instantaneous release	C
Rated short circuit breaking capacity Icu(A)	4500



DZ30N-32

3. Applicable Conducting Wire

Rated current(A)	Norminal cross section of wire mm ²
$I_n \leq 6$	1
$6 < I_n \leq 13$	1.5
$13 < I_n \leq 20$	2.5
$20 < I_n \leq 25$	4
$25 < I_n \leq 32$	6

4. The Over-current Protection Property

Ambient temperature	Initial status	Test current	Test time	Expected result	Note
30±2°C	Cold position	1.13I _n	t ≥ 1h	Non-release	—
	Carried out immediately after previous test	1.45I _n	t < 1h	Release	—
	Cold position	2.55I _n	1s < t < 60s	Release	Current smoothly rises to specified value within 5s
-5~+40°C	Cold position	5I _n	t ≥ 0.1s	Non-release	Type C
	Cold position	10I _n	t < 0.1s	Release	Type C

5. Dimension

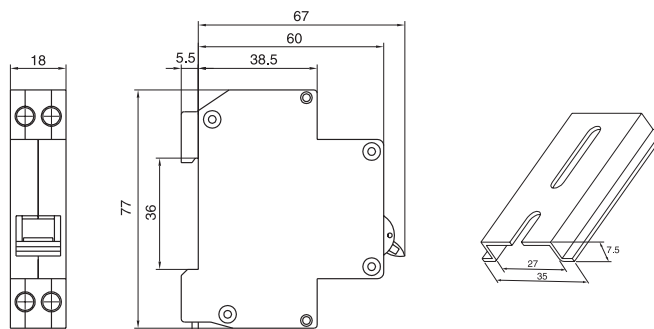



DZ30LE-32



DZ30LE-32

1. Application

DZ30LE-32 is used in the single phase circuit of AC 50/60Hz, rated voltage 230V, used as electron shock protection. It can protect circuit form overload and short circuit. This product has advantages of small volume, high breaking capacity, live and zero wire are cut off at the same time, also protecting person from electric shock when the live wire connected opposite. It conforms with the standards of IEC61009.

2. Main Technical Parameter

Type	DZ30LE-32
Pole	1P+N
Rated current (A)	6,10,16,20,25,32
Rated voltage(V)	230
Rated residual action current I Δ n(A)	0.03
Rated residual non-action current I Δ no(A)	0.015
Rated residual making/breaking capacity I Δ m(A)	500
Type of instantaneous release	C
Rated making/breaking capacity Im(A)	4500

3. Applicable Conducting Wire:

Rated current(A)	Norminal cross section of wire mm ²
I n \leq 6	1
6<I n \leq 13	1.5
13<I n \leq 20	2.5
20<I n \leq 25	4
25<I n \leq 32	6

4. Residual Current Breaking Time

I n (A)	I Δ n (A)	Breaking time(s) when equals to rating following				
		I Δ n	2I Δ n	5I Δ n	5,10,20,50,100,200,500 ^a (A)	I Δ t ^b
6-32	0.03	0.1	0.06	0.04	0.04	0.04

5. The Over-current Protection Property

Ambient temperature	Initial status	Test current	Test time	Expected result	Note
30 \pm 2 $^{\circ}$ C	Cold position	1.13I n	t \geq 1h	Non-release	-
	Carried out immediately after previous test	1.45I n	t<1h	Release	-
	Cold position	2.55I n	1s<t<60s	Release	Current smoothly rises to specified value within 5s
-5 \sim +40 $^{\circ}$ C	Cold position	5I n	t \geq 0.1s	Non-release	Type C
	Cold position	10I n	t<0.1s	Release	Type C

6. Dimension

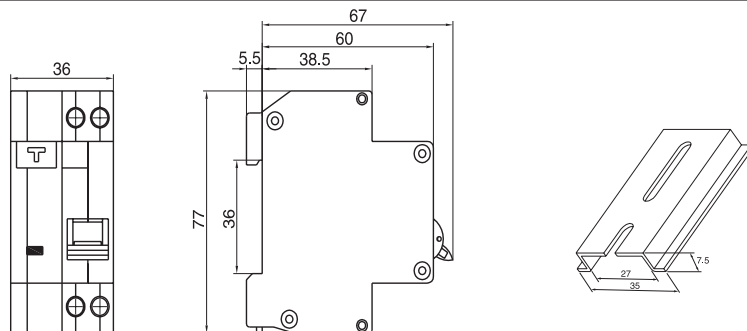

DZL4 Residual Current Circuit Breaker

1. Application

DZL4 RCCB is in conformity with the standard of IEC61008. The RCCB can cut off the fault circuit immediately on the occasion of shock hazard or earth leakage of trunk. Thus, it is suitable to avoid the shock hazard and fire caused by earth leakage.

The RCCB is mainly suitable for use in varieties of plants and enterprises, building construction 1 phase 230V and 3 phase 400V 50/60Hz. RCCB is not suitable for use on DC pulse system.

2. Specification

Number of Poles	2P, 4P
Rated Current (A)	16, 20, 25, 40, 50, 63
Rated Residual Operating Current (I Δ n)(mA)	30, 100, 300, 500
Rated Voltage (V)	AC 230/240 AC 400/415
Residual Operating Current Scope	0.5I Δ n~I Δ n
Residual Current Off-time	≤ 0.3S
Short Circuit Capacity (Icu)	6000A
Endurance(times)	4000
Protection Degree	IP20



DZL4 2P



DZL4 4P

3. Dimension

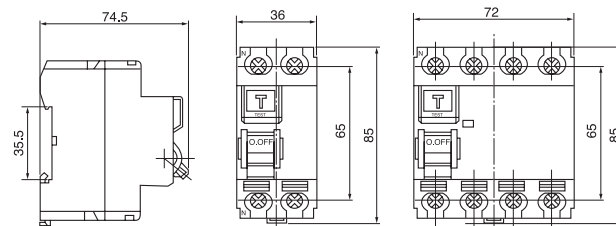

DZL5 Residual Current Circuit Breaker

1. Application

DZL5 residual current breaker is used in circuits up to single phase 230V, three phase 400V 50/60 Hz. RCCB is not suitable for use on DC pulse system. The RCCB can cut off the fault circuit immediately on the occasion of shock hazard or earth leakage of trunk. Thus it is suitable to avoid the shock hazard and fire caused by earth leakage. The RCCB is mainly suitable for use in variety of plants and enterprises, building construction, commerce, guesthouses and families. It conforms with the standards of IEC61008.

2. Main Technical Parameter

Type	DZL5
Pole	2P, 4P
Rated current I n (A)	25,40,63,80,100
Rated residual operating current (I Δ nA)	10,30,100,300,500
Rated non-operating current for earth leakage I Δ n(A)	0.5I Δ n
Rated voltage U n (V)	240(220) 415(380)
Residual current off-time:	Y0.1s
Minimum value of rated making and breaking capacity	1kA
Rated conditional short-circuit current (I c)	I n =25,40A I c =1500A I n =63A I c =3000A

3. Dimension

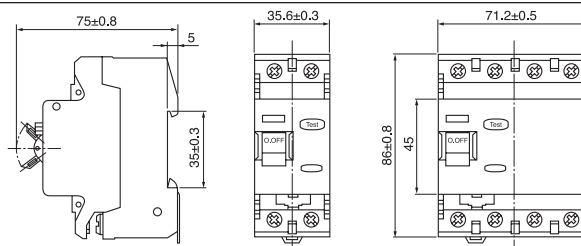

DZL5 2P



DZL5 4P